



# JETFLOW SJMF

**ELTA** >>>  
**TRADE**

## JETFLOW SJMF

### EC In-line Mixed Flow Circular Fan

Compact EC in-line mixed flow fan, designed specifically for use with rigid or flexible ductwork. Perfect for residential, industrial and commercial installations.

#### IMPROVES INDOOR AIR QUALITY

Better health and reduced heating costs.



Available in 7 sizes from 100mm – 355mm.



High performance and energy efficient brushless EC motor results in low SFP.



Integrated mounting foot simplifies installation.



Easy control with industry-standard 0-10v connection. Allows quick connection to sensors and run-on timers.

AVAILABLE ON

**i-sells.co.uk**

The UK's Leading Ducting  
And Ventilation Supplier

01384 275771

info@eltatrade.co.uk

[www.eltatrade.co.uk](http://www.eltatrade.co.uk)



**WE COULDN'T FIT  
EVERYTHING ON HERE,  
SCAN THE QR CODE TO  
FIND OUT MORE**



## FEATURES & BENEFITS

- **EC brushless motor** means even at full speed, its performance is smooth, quiet and super efficient.
- **Double mixed flow impeller** produces strong pressure at any speed, allowing the fan to be slowed down and deliver the exact performance needed. This reduces heat loss through over-ventilation.
- **Detachable Bracket** on models 150 to 315mm for ease of installation.
- **Speed controllable** and can be paired with optional accessories and sensors for complete control.
- **Easy Installation;** fitted with a 1.5 metre mains lead complete with UK 3-pin plug. Convenient for connecting to electrical sockets and providing a means of isolation/disconnection.
- **Low power consumption** at high performance resulting in Low Specific Fan Powers for Building Regulation Compliance.
- **2 year warranty,** for full details, visit [www.eltatrade.co.uk](http://www.eltatrade.co.uk).

## PERFORMANCE DATA

JETFLOW SJMF	100	125	150	200	250	315	355
<b>Airflow L/s (m³/h) @ 100pa</b>	48 (173)	68 (245)	130 (468)	253 (911)	427 (1538)	773 (2783)	1140 (4104)
<b>Power W</b>	21	27	49	100	172	375	538
<b>Sound Pressure dB(A) @ 3m</b>	47	48	51	52	56	62	66
<b>Volts   Hertz</b>	220-240   50/60						
<b>Max Ambient Temperature °C   Degree of Protection</b>	60   IPX4						

For full technical data, please refer to [www.eltatrade.co.uk](http://www.eltatrade.co.uk).

## DIMENSIONS

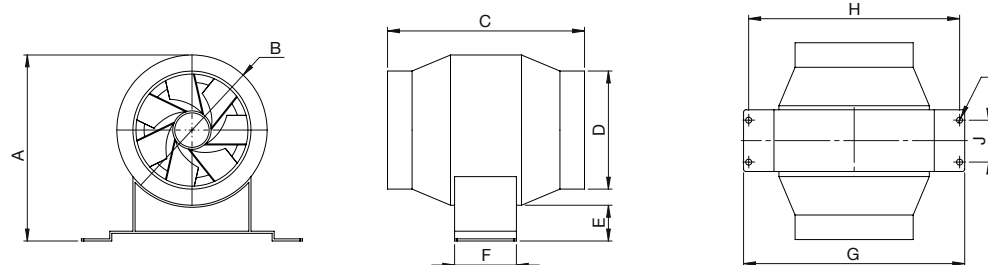

MODEL	A	ØB	C	ØD	E	F	G	H	J	K	Weight kg
SJMF 100	150	125	159	98	25	51	184	175	37	5	1.1
SJMF 125	151	126	110	124	26	51	184	175	37	5	1.1
SJMF 150	173	153	165	150	21	80	187	175	37	5 x 8 SLOT	1.6
SJMF 200	223	203	220	200	22	105	221	210	39	5 x 8 SLOT	2.6
SJMF 250	274	254	210	250	22	105	300	288	26	5 x 8 SLOT	3.7
SJMF 315	356	317	290	313	39	164	360	336	68	9 x 14 SLOT	8.5
SJMF 355	401	358	330	353	45	184	405	380	77	9 x 14 SLOT	12.0

Dimensions in mm.

AVAILABLE ON

**i-sells.co.uk**  
The UK's Leading Ducting  
And Ventilation Supplier



A MEMBER OF

**eg** ELTA GROUP