



**100 & 150
MODELS**

DEXA dMEV

ELTA >>>
TRADE

DEXA dMEV

Decentralised Mechanical Extract Ventilation

Energy efficient continuously running trickle & boost extract fan, with intelligent timer and humidity sensor to automatically boost airflow when needed.

IMPROVES INDOOR AIR QUALITY

Better health for the building and its occupants.



Very low power consumption: the EC motor is optimised for continuous running.



Intelligent humidity control increases ventilation only in response to actual variations in humidity, preventing unnecessary heat loss, energy consumption and noisy running.



Intelligent run-on timer adapts the fan operation to the users' habits.



Totally recyclable plastic components; environmentally friendly.

01384 275771

info@eltatrade.co.uk

www.eltatrade.co.uk

**WE COULDN'T FIT
EVERYTHING ON HERE,
SCAN THE QR CODE TO
FIND OUT MORE**



FEATURES & BENEFITS

- **Low power consumption;** optimised for continuous running.
- **Intelligent run-on timer** adapts the fan operation to the users' habits. The run-on period depends on the length of time the switched live connection is activated and to ensure the lowest noise levels, especially at night (if switched live connection is activated for less than 3 minutes, the unit speed does not increase).
- **Constant flow option;** to speed up or slow down the unit depending on resistances caused by the length of ducting and/or external windy conditions.
- **Multi-speed** with adjustable minimum and intermediate speeds.
- **Aesthetic front cover** modern interior fascia design which is easily removed for cleaning without the need for tools.
- **Wall, ceiling and window mountable** (relevant accessories available).
- **IPX4** rated.
- **Totally recyclable plastic components;** environmentally friendly.
- **5 year warranty,** for full details, visit www.eltatrade.co.uk.

» **5
YEAR
WARRANTY**

PERFORMANCE DATA

DEXA dMEV	100		150	
	Min	Max	Min	Max
Airflow L/s (m³/h)	5 (18)	25 (90)	5 (18)	50 (180)
Power W	1.0	5.8	0.7	6.5
Sound Pressure dB(A) @ 3m	<9	38	<9	36
Volts	220-240			
Hertz	50/60			
Max Ambient Temperature °C	40			
Degree of Protection	Wall: IPX4		Ceiling: IPX2	

Figures from "through the wall" installation BRE test results. For full technical data, please refer to www.eltatrade.co.uk.

DIMENSIONS

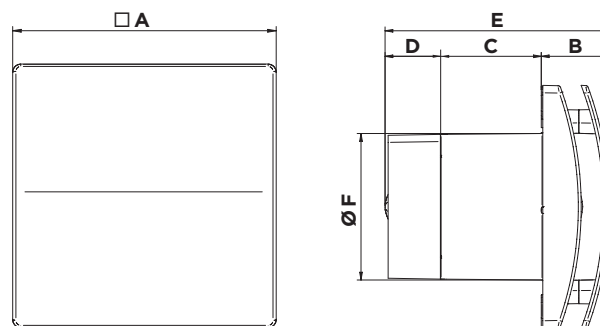

Dimensions in mm.



Model	A	B	C	D	E	F
DEXA dMEV 100	164	46	70	36	152	99
DEXA dMEV 150	218	52	97	-	149	148